

European Solar and Energy Storage Solutions

Latest specifications for photovoltaic panel ground layout



Overview

The 2016 edition of ASCE 7 has been in effect for about three years. It has three more years remaining before the standard is superseded by ASCE 7-22. ASCE 7-16 introduced substantial increases in the component and cladding pressure coefficients used to calculate wind pressure in various wind zones. This change had.

The 2022 edition of ASCE 7 includes an update to Section 13.6.12 that says, “The solar panels shall not be considered as part of the load path that.

Cain identified several code development issues for SEAC to monitor. Strong guidance exists for low-profile systems on low-slope roofs. However, Cain is keeping an eye on the edge factor.

Research by the Structural Engineers Association of California (SEAOC) formed the basis for key provisions of ASCE 7-16. See the following white papers for research on seismic.

Find out how the ASCE 7 standard affects wind load, seismic load, and tornado load considerations for solar photovoltaic (PV) systems.

Find out how the ASCE 7 standard affects wind load, seismic load, and tornado load considerations for solar photovoltaic (PV) systems.

A methodology for estimating the optimal distribution of photovoltaic modules with a fixed tilt angle in ground-mounted photovoltaic power plants has been described. It uses Geographic Information System, available in the public domain, to estimate Universal Transverse Mercator coordinates of the area which has been selected for the .

PV power plants consist of arrays of ground-mounted PV panels. In this study, 3D computational fluid dynamics (CFD) simulations based on the shear-stress transport $k-\omega$ turbulence model were performed to study airflow around ground-mounted PV panel arrays.

Abstract: This guide is primarily concerned with the grounding system design for photovoltaic solar power plants that are utility owned and/or utility scale (5 MW or greater). The focus of the guide is on differences in practices from

substation grounding as provided in IEEE Std 80.

The RERH specifications and checklists take a builder and a project design team through the steps of assessing a home's solar resource potential and defining the minimum structural and system components needed to support a solar energy system. The following document also provides recommendations on What are solar photovoltaic design guidelines?

In addition to the IRC and IBC, the Structural Engineers Association of California (SEAOC) has published solar photovoltaic (PV) design guidelines, which provide specific recommendations for solar array installations on low-slope roofs 3.

What are the design and engineering requirements for solar panels?

These requirements vary depending on the type of installation, such as rooftop or ground-mounted systems, as well as the specific location and environmental factors. Proper design and engineering of solar panel structures must take into account several factors, such as wind loads, snow loads, and seismic forces.

What are the structural requirements for solar panels?

Structural requirements for solar panels are crucial to ensure their durability, safety, and efficient performance. These requirements vary depending on the type of installation, such as rooftop or ground-mounted systems, as well as the specific location and environmental factors.

Does a ground-mounted photovoltaic power plant have a fixed tilt angle?

A ground-mounted photovoltaic power plant comprises a large number of components such as: photovoltaic modules, mounting systems, inverters, power transformer. Therefore its optimization may have different approaches. In this paper, the mounting system with a fixed tilt angle has been studied.

What is the optimal configuration for a photovoltaic panel array?

Under wind velocities of 2 m/s and 4 m/s, the optimal configuration for photovoltaic (PV) panel arrays was observed to possess an inclination angle of 35°, a column spacing of 0 m, and a row spacing of 3 m (S9), exhibiting the highest ϕ value indicative of wind resistance efficiency surpassing 0.64.

What is the structural load of solar panels?

The structural load of solar panels refers to the weight and forces a solar system exerts on a building or structure. This can include the weight of the panels, mounting system, and other related equipment, as well as additional loads from wind, snow, or seismic activity.

Latest specifications for photovoltaic panel ground layout



CHAPTER 5 CS PHOTOVOLTAIC SYSTEMS

The structure of a roof that supports solar photovoltaic panels or modules shall be designed to accommodate the full solar photovoltaic panels or modules and ballast dead load, including concentrated loads from support frames in ...

Design and Analysis of Steel Support Structures Used in Photovoltaic ...

In the photovoltaic (PV) solar power plant projects, PV solar panel (SP) support structure is one of the main elements and limited numerical studies exist on PVSP ground ...



Standard, Specification & Benchmark Cost , MINISTRY OF NEW ...

Updated Specification and Testing procedure for the Solar Photovoltaic (SPV) Water Pumping System and Universal Solar Pump Controller (USPC)(22/03/2023, 2.5MB, PDF) Specification ...

Solar Panel Wiring Basics: Complete Guide & Tips to Wire a PV ...

You should know that there are limitations for series solar panel wiring. In the U.S., solar strings are required to feature a maximum voltage of 600V, so solar arrays comply ...



Technical specifications for solar PV installations

o IEC 61646: Thin-film terrestrial photovoltaic (PV) modules - Design qualification and type approval
 o IEC 61730: Photovoltaic (PV) module safety qualification Standard Specifications ...



Solar Panel Structure - Design & Manufacturer in India

In the railed mounting system, 4 rails are used to fix 2 rows of solar panel. While in the shared rail system only 3 rails will be used to mount 2 rows. The middle rail will be shared by both the ...



- High energy density and long cycle life
- Modular structure



- No need to replace the battery
- Shorter charging time
- Meets #1 EV car

Best Solar Panel Layout Tool 2024 , ARKA 360

Top 5 Solar Panel Layout Tool: Let's now look at the top 5 solar panel layout tool used by solar PV installers:-ARKA 360. ARKA 360 is a SaaS and AI cloud-based software for solar design and sales growth. It specializes ...

Solar Photovoltaic: SPECIFICATION, CHECKLIST AND GUIDE ...

the mounted aluminum framed PV panels (i.e., other PV technologies or ground mount systems), EPA recommends that an installer certified by the North American Board of Certified Energy ...

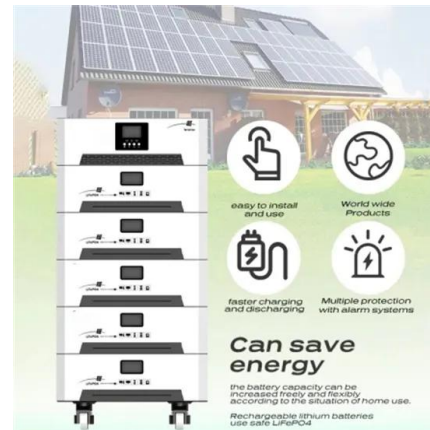

Solar Panel Dimensions and Sizes: Complete Guide

Average Solar Panel Size: Available roof space, solar panels size, and the load your roof can support. Solar Irradiance: Earth has many places with different sunlight hours and sums of solar energy. Local Climate: Mild climates ...

Ground-Mount Solar Buyer's Guide 2021: Fixed Tilt ...

Posts per row: Dependent on soil conditions, type of posts and row length -- average is 11 to 13 per row. Row lengths: While 96 modules per row is most common, OMCO Solar can customize to accommodate up to 112. ...



Structural Requirements for Solar Panels -- Exactus ...

These requirements vary depending on the type of installation, such as rooftop or ground-mounted systems, as well as the specific location and environmental factors. Proper design and engineering of solar panel ...



Solar Panel Wiring Basics: Complete Guide & Tips to ...

You should know that there are limitations for series solar panel wiring. In the U.S., solar strings are required to feature a maximum voltage of 600V, so solar arrays comply with article 690 section 7 of the National ...

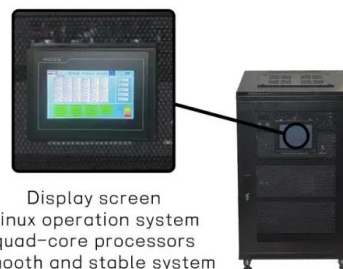

Solar Panel System Is Properly Grounded , RenewGenius

Properly grounding a solar panel system is crucial to ensure safety, optimize performance, and comply with local codes and standards. Grounding refers to connecting electrical equipment or ...

Contact Us

For catalog requests, pricing, or partnerships, please visit:
<https://www.ssab-proiect.eu>